

ALCOM
Quality Lifestyle

Caller ID Telephone



AT-5928 USER'S MANUAL

INTRODUCTION

Thank you for purchasing our newest Alcom Caller ID phone. This manual is designed to familiarize you with this phone. To get the maximum use from your new phone, we suggest that you read this instruction manual carefully before using.

SAFETY INSTRUCTION

When using your telephone equipment, the following basic safety precautions should always be followed to reduce the risk of fire, electric shock and injury to persons:

1. Read, understand and follow all warnings and instructions
2. Unplug the product from the wall outlet before cleaning. Do not use liquid cleaners or aerosol cleaners. Use a soft damp cloth for cleaning.
3. Do not place this product on unstable surfaces. The product may drop, causing serious damage to the product.
4. Do not overload wall outlets and extension cords as this can result in fire or electric shock.
5. Never push foreign objects of any kind into this product through cabinet slots as they may affect dangerous voltage points or short circuit parts that could result in fire or electric shock. Never spill liquid of any kind on the product.
6. Avoid moving or disconnecting this unit during a heavy storm, as there may be a remote risk of electric shock from lightning and thunder.
7. Unauthorized persons cannot open or service even if there is a defect with the unit. This will void the warranty, please send to service center for any defects.

FEATURES

- FSK/DTMF/ETSI compatible with auto-detection.
- 16-digit LCD display
- 99 incoming, 18 outgoing number memories
- 3 one-touch memory and 10 two-touch memories
- 16 kinds of ringing tones for selection
- Hold on music
- Do Not Disturb function
- Intercom and transfer function between parallel phones (using 2 similar models)
- Secret code function in Do Not Disturb state to avoid missing VIP calls
- Pre-dial and edit function
- Redial and auto-redial function
- 3-step lock function and 5 sets of alarm clock
- 16 levels of LCD contrast
- Key tone function
- Set PABX code
- Pulse/Tone dialing mode compatible
- 3 levels of hands free volume for selection
- Ringing volume selection
- Calculator function
- In use and new call LED indicator
- Protection from parallel operation
- Handsfree Dialing function

LOCATION DESCRIPTION

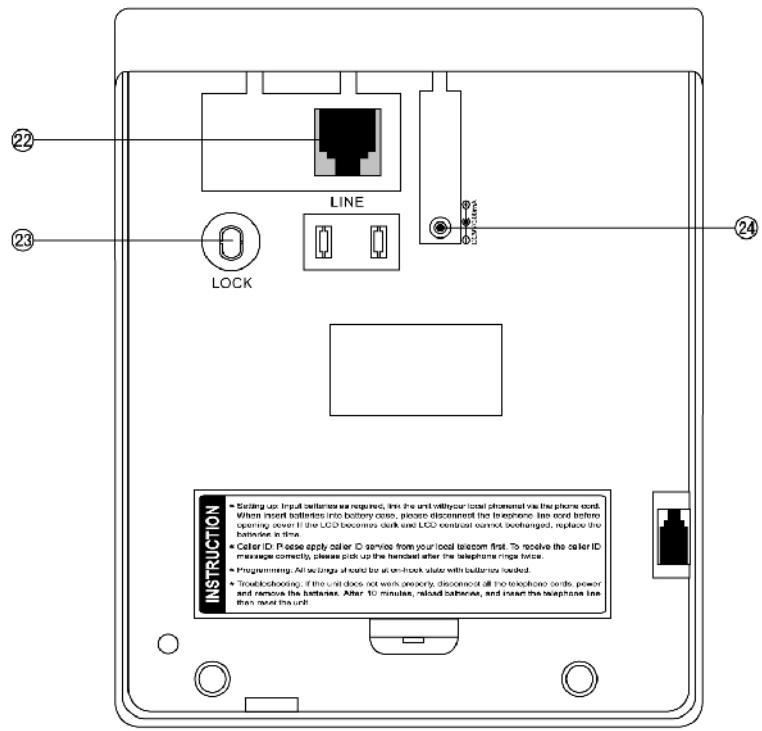
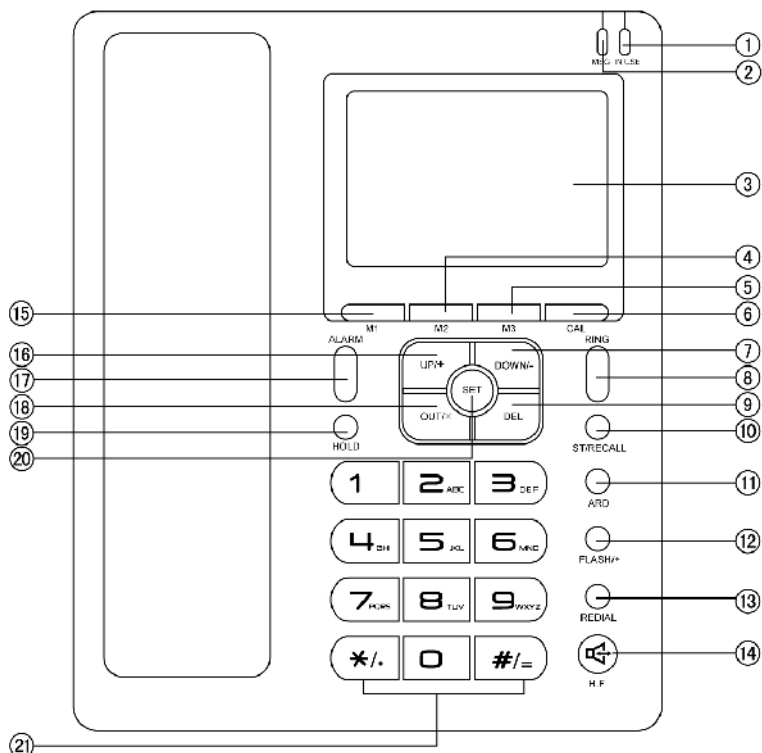

- | | | | | | |
|----------|-------------|-----------|----------|--------------|-----------------|
| ① IN USE | ⑥ CAL | ⑪ ARD | ⑬ REDIAL | ⑰ HOLD | ⑲ M1 |
| ② MSG | ⑦ DOWN/- | ⑫ FLASH/+ | ⑭ H.F | ⑱ SET | ⑳ NUMERICAL KEY |
| ③ LCD | ⑧ RING | ⑬ REDIAL | ⑮ M2 | ⑳ SET | ㉑ LINE |
| ④ M2 | ⑨ DEL | ⑭ H.F | ⑯ M3 | ㉒ LOCK | ㉓ DC9V/300mA |
| ⑤ M3 | ⑩ ST/RECALL | ⑮ M1 | ⑰ HOLD | ㉔ DC9V/300mA | |

GETTING STARTED

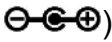
1. The unit requires 3 X 1.5V AA batteries. Open the battery compartment cover and insert the batteries in the right polarity, then close the cover (Proposal using alkaline battery). Or you can buy a DC transformer (AC-DC adapter, Input Alternating Current 220V, Output DC 9V, Current above 300mA, with the polarity ) instead of battery, pay attention not to plug in reverse polarity.. There should be time display on the liquid crystal screen after the batteries are inserted or DC is connected
2. Insert one end of the line cord to the line jack of the base and the other end to the wall outlet of exchange.
3. Connect the handset and the unit with coiled cord.
4. Setting the dialing mode to correct mode according to the directions from your local telecom.
5. Apply for the caller ID from your local telecom office.

RECEIVING A CALL

1. When a call comes, the telephone rings, and LCD displays the seq. number of the call, the date, time, incoming number and the **NEW** icon. The **MSG** LED indicator will flash when missed called.
2. If the same number is received again, and the previous call has not been reviewed, the LCD displays **REP** icon.
When the incoming memory is full, the latest incoming number replaces the oldest number in the memory

NOTE: For the phone to display incoming number and other information, you must have an active Caller ID subscription with your local telephone exchange company.

➤ From handset

1. Pick up the handset and talk to the other party.
2. When finished, return the handset to the base.

➤ Switching to Hands free mode

1. When using the handset, press **H.F** key and return the handset to the base.
2. When finished, press **H.F** key again.

➤ From Hands free mode

1. When the telephone rings, press **H.F** key and talk to the caller. For the other party to hear your voice clearly, speak into the MIC from a distance of 32cm or less.
2. When finished, press **H.F** key again.

NOTE:

Generally telecom transmits the incoming message between the first ring and the second ring. So please answer the phone after the second ring.

MAKING A CALL

➤ From handset

1. Pick up the handset.
2. When you hear the dial tone, dial the desired number.
3. The unit will start to time the conversation after 6 seconds.

4. When finished, return the handset to the base.

➤ **From Hands free mode**

1. Press **H.F** key
2. When you hear the dial tone, dial the desired number.
3. The unit will start to time the conversation after 6 seconds.
4. When finished, press **H.F** key again.

➤ **Pre-dialing function**

1. When the handset is on the base, dial the desired number.
2. If there are mistakes, use the **DEL** key to edit.
3. Press **H.F** key or pick up the handset and the number will be dialed automatically.

➤ **Redial:**

1. Pick up the handset or press **H.F** key,
2. Press **REDIAL** key, the last dialed number will be dialed again

➤ **Auto-redial: (this function just for your selection)**

1. Press **H.F** key, dial a number, if you hear an engaged tone.
2. Press **ARD** key and the last dialed number will be redialed automatically at every 9-10 seconds until the line is through.
3. The phone will redial the same number automatically for 32 times.

When there is an incoming call while using auto-redial, pick up the handset or press **H.F** key to answer the call. The auto redial function will be terminated.

REVIEWING, CALLING BACK AND DELETING INCOMING NUMBERS

➤ **Reviewing**

On-hook state. Press **UP/+** or **DOWN/-** key to scroll and review the numbers.

➤ **Deleting**

When the desired number is shown, press **DEL** key, the number is deleted.

Press and hold **DEL** key for 3 seconds; all the incoming numbers are deleted.

➤ **Calling back**

1. Scroll to the desired number, press **H.F** key or pick up the handset, and the number is dialed out, or
2. Press **REDIAL** key, LCD displays **PICK UP**,
3. Press **H.F** key or pick up the handset, the number is dialed out.

NOTE: If the PABX code is set, the telephone will add the code before the number automatically when dialing back the number. It will dial the PABX code first and then after a 2 second pause and then dial the number.

NEW INCOMING CALL LED AND RINGING LED

New and ring indicator is the same LED, when a new call comes in, the LED is blinking, when a new number has not been reviewed, the LED is blinking in 4s interval.

PREVENTING FSK MESSAGE TO AUTO-ADJUST REAL TIME

When a FSK message comes, the unit adjusts real time automatically, you can prevent real time auto adjustment as follows:

1. In on-hook state, press and hold **ALARM** key for 3 seconds, LCD displays **DATE OFF**,
2. Press **ALARM** key again, LCD displays **DATE ON**,
3. Press **SET** key to quit.

NOTE: DATE OFF: Does not allow real time auto adjustment

REVIEWING, CALLING BACK AND DELETING OUTGOING NUMBERS

➤ Reviewing

In on-hook state, press **OUT/X** key, then repeat **OUT/X** to review outgoing numbers one by one.

➤ Calling back

1. In on-hook state, press **OUT/X** key to review the desired number, then press **H.F** key or pick up the handset, and the number is dialed out, or
2. Press **REDIAL** key, LCD displays **PICK UP**, press **H.F** key or pick up the handset, the number is dialed out.

➤ Deleting

1. In on-hook state, press **OUT/X** key to scroll to the desired number.
2. Press **DEL** key and the number is deleted, or
3. Press and hold **DEL** key for 3 seconds. All numbers will be deleted.

SETTING MENU

➤ Setting date & time

1. In on-hook state, press **SET** key, the value for the year flashes.
2. Press **UP/+** or **DOWN/-** key to edit the year.
3. Press **SET** key to confirm and enter the next value month setting.
4. Repeat the year setting step to set the month.
5. Repeat the above steps for date and time setting.

➤ Setting Local Area Code and Long Distance Code

1. After setting up the date and time, press **SET** key. LCD displays **CODE 0 ----**and the long distance code" **0**" flashes,
2. Press **UP/+** or **DOWN/-** key to edit the flashing code from 0 to 9.
3. Press **SET** key to confirm and enter the next flashing code setting.
4. Repeat the above steps for the rest code setting.

➤ Adjusting LCD Contrast

1. After setting up the local area code, press **SET** key, LCD display **LCD 08**
2. Press **UP/+** or **DOWN/-** key to adjust the LCD contrast, total 16 levels can be selected.
3. Press **SET** key to confirm and exit.

Alternatively in on-hook state, press FLASH/÷ key to enter LCD contrast setting directly, then press FLASH/÷ key continuously to adjust the LCD contrast.

➤ Setting Alarm Clock

1. In on-hook state, press **ALARM** key once, LCD displays **12-00 AL1**,
2. Press **UP/+** or **DOWN/-** key to select ON or OFF. LCD displays "**ALM**" icon when the alarm is set to ON.
3. Press **SET** key, value "**12**" starts to flash.
4. Press **UP/+** or **DOWN/-** key to set the alarm hour and press **SET** key to confirm and enter alarm minute setting.
5. Press **UP/+** or **DOWN/-** key to edit alarm minute and press **SET** key to confirm and go to next group alarm clock setting.
6. Repeat the above steps to set additional alarms.

NOTE: The first 3 groups alarm clock will be repeated periodically every day while the last 2 groups alarm clock is effected one time.

SECRET CODE SETTING AND REMOTE MONITOR FUNCTION

➤ Setting

1. In on-hook state, press and hold **RING** key for 3 seconds, LCD displays **Pin ----**.
2. Input a 4-digit of PIN using the numeric keys.
3. Press **DEL** to edit the secret code, press **SET** to confirm.
4. When the last digit of the secret code is **#**, the telephone will activate remote monitor function.
5. Set the ringer to **OFF**. (Please refer to section “**SETTING RINGING TONE**”).

➤ Usage

1. **Secret code:** When caller call this telephone, he/she will hear the usual ringing tone (when the line gets through) three times or four times. However, the telephone unit will not ring. The caller will hear a short “di” sound, which means that the caller need to key in the secret code. Once the caller keys in the correct code, the telephone unit will ring. Press **H.F** key or pick up the handset to have the conversation with the caller.
2. **Remote monitor:** If the last digit of the secret code is **#**, after the caller keys in the correct secret code, the telephone unit will go into hands free mode automatically.
3. If the caller keys in the wrong code, he/she will have to call again and key in the correct secret code PIN.

NOTE: This function is useful only when the telephone ringer is set to OFF. The caller must know the secret code in order to dial through the line.

INTERCOM AND TRANSFER BETWEEN PARALLEL PHONES

➤ Setting paging number

1. In on-hook state, press and hold **SET** key, LCD displays **EL--**
2. Key in “*” and paging number(example “*1”and “*2”), use **DEL** key to edit
3. Press **SET** key to confirm and exit.

➤ Transferring the line from paralleled phones:

- 1) In on-hook state, use one of paralleled phone to call this unit. Press “*” and the paging

number that was set in another telephone unit, the unit rings. Pick up its handset or press  key to have intercom conversation. Paralleled phones can call each other by the same way.

2) When a call comes, use one of paralleled phone to answer. Press the “*” and paging number

that was set in another telephone unit, the unit rings, pick up its handset or press  key to

answer the incoming call.

Notice: Please use same series phones to intercom and transfer as above operation.

If different phone is connected in parallel, only can transfer call from the other phone to this phone and no intercom is possible. If the paging number is set Anti-steal dialing

function will not work. Any special services starting with “ * ” offered by your Telephone

company may not function properly. Please deactivate Intercom function to use those special services.

ANTI- DIALING FROM PARALLEL PHONE

1. In on-hook state, press and hold **#/=** key for 3 seconds, LCD displays **SPI ON**
2. Press **H.F** key twice and then
3. Press and hold **#/=** key for 3 seconds again, LCD displays **SPI OFF**,
When the anti-dial is set to ON, users who want to dial using an extension to dial via the same line will hear a “DI-DI, DI-DI” beep continuously and will not be allowed to make a call.

Note: If page number is set this function will not work.

SETTING RINGING TONE AND ADJUST RINGING VOLUME

There are 16 kinds of ringing tones and ringing OFF for selection:

1. In on-hook state, press **RING** key, LCD displays **ring 02 db8**
2. Press **RING** to select the desired ringing or set ring OFF.
3. Press **UP/+** or **DOWN/-** key to set ringing volume
4. Press **SET** to confirm and exit.

NOTE: The volume ranges from 1db-8db, with 8db being the loudest. Use **UP/+** or **DOWN/-** key to adjust the ring volume. Ring OFF is “**Do Not Disturb**” mode. If the phone is set to this mode, the telephone will not ring when there is an incoming call.

ADJUST HANDSFREE VOLUME

In hands free mode, press **UP/+** or **DOWN/-** to adjust the handsfree volume, LCD displays the volume level and there are a total of 3 levels.

SELECTING PULSE OR TONE DIALING MODE

1. In on-hook state, press and hold ***/.** key for 3 seconds, LCD displays **P**, then dialing mode is set as Pulse.
2. Press **H.F** key twice and hold ***/.** key for 3 seconds again, LCD displays **T** then dialing mode is set as Tone.

SETTING PABX CODE

1. In on-hook state, press and hold **DEL** key 3 seconds to set PABX code, LCD displays **SET PCODE-** and the “-” flashes.
2. Press **UP/+** or **DOWN/-** key to set PABX code from 0 to 9.
3. If choose “-”, it means no PABX code has been set.
4. Press **SET** key to confirm and quit.

HOLD ON MUSIC

- **When talking over handset, press HOLD key to enter the hold mode and the hold music is sent out. In hold mode**
 1. Press **HOLD** key to release hold mode and continue to talk over handset, or
 2. Hang up handset, it enters hands-free hold mode.
- **When talking at hands-free mode, press HOLD key to enter the hold mode and the hold music is sent out. In hold mode**
 1. Pick up handset to talk over handset, or
 2. Press **H.F** key to quit hold mode and talk at hands-free mode.

ONE TOUCH MEMORY OPERATION

➤ Store the number in one-touch memory

1. Pre-dial the desired number or checking incoming and outgoing number that you want to store.
2. Press **ST/RECALL** key
3. Press **M1** or **M2** or **M3** key

➤ Make a call from one-touch memory

In off-hook or on-hook situations, press **M1** or **M2** or **M3** key to dial the stored number out.

TWO TOUCH MEMORY OPERATION

➤ Store the number in two-touch memory

1. Pre-dial the desired number or checking incoming and outgoing number that you want to store.
2. Press **ST/RECALL** key
3. Press one of digit key (0-9)

➤ Make a call from two-touch memory

In off-hook or at hands-free state, press **ST/RECALL** key + digit key (0-9) key, the relevant number will be dialed out.

LOW BATTERY DETECTION

When the voltage is lower than 3.9v, LCD displays “” icon to remind the user to replace the batteries.

LCD BACKLIGHT FUNCTION

The backlight is turned on when receiving an incoming call, dialing, pressing any key or in MUSIC HOLD mode. It will fade off if the telephone is left idle for 10 seconds.

NOTE: If batteries are not installed or DC adaptor is not inserted, there will be no LCD backlight function.

FLASH FUNCTION

When dialing and the line is engaged, press **FLASH/±** key and then press **REDIAL** key to dial it out again.

LOCK

Turn the key to yellow point, all numbers are locked except emergency numbers 119, 120, 122, 110.

Turn the key to green point, all numbers starting with “0” are locked

Turn the key to red point, all numbers are allowed to be dialed out .

KEY TONE

1. In on-hook state, press and hold **CAL** key 3 seconds, key tone is active when hearing “di” voice.
2. Press and hold **CAL** key 3 seconds again, key tone is inactive when hearing “di” voice. 

CALCULATOR FUNCTION

In on-hook state, press **CAL** key, LCD displays **0-**, the unit is in calculator state.

The unit is available for operation of “+.-.x.÷”, in the calculator state, **#/=** key is used as “=” and the ***./.** key is used as “.”, **OUT/x** and **FLASH/÷** are used as **x** and **÷** respectively. **UP/+** or **DOWN/-** key is used as sign of positive/negative.

Eg.1(10+26) ÷2

1. In on-hook state, press **CAL** key
2. Press (**1** , **0** , **+** , **2** , **6**), **÷** , **2** , **#/=** keys
3. After calculated, press **SET** key to quit.

Eg.2 0.5× 0.6-1

1. In on-hook state, press **CAL** key
2. Press **0** , ***./.** , **5** , **x** , **0** , ***./.** , **6** , **-** , **1** , **#/=** keys
3. After calculated, press **SET** key to quit.

NOTES

Please unplug telephone line and power (if any) when installing / replacing batteries.

TROUBLESHOOTING

? **No voice**

- + Check if the handset is on the phone or if the line has terminated.

? **Receive only**

- + Check if P/T mode is properly set.
Check if the unit is locked (use the key to unlock it)

? **Rusty batteries or leakage**

- + Remove the rust or wipe away the leakage.

? **Noise**

- + Check if the connector is wet or rusty (Change the connector)

? **Ring once then disconnect when receiving a call. Dialing function is still available**

- + Check if connector is in a moist environment.
Check if too many extensions are used together or the quality of extension is not good enough

? **LCD become dim**

- + Check if LCD contrast is properly set or if the batteries are weak. (Adjust LCD contrast, if the LCD is still dim, replace the batteries.)

? **No ring**

- + Check if the RING tone is in the OFF state, reset it.

? **Most of the functions failed**

- + Check if the batteries are strong enough. (Change the batteries)
If batteries are ok (Remove the battery, unplug the lines and reinstall after 10 minutes)

Note: Due to continuous product development all features and specifications are subject to change without prior notice