



motorola



# IT.6.1

## impossibly thin

Digital cordless telephone

Mobile connectivity with  
Bluetooth® wireless technology

### KEY FEATURES

- Large 2.2" 65K full colour display
- High quality audio
- Studio crafted ringtones
- Laser etch backlit keypad
- Block unwanted callers
- Do Not Disturb mode
- Bluetooth® mobile connectivity
- Make & receive mobile calls
- Charge your mobile via USB
- Sync up to 1000 mobile contacts
- Connect up to 2 mobiles + 1 headset



reddot award 2014  
winner

# Beautifully engineered. Precision crafting. High quality execution.

Driven by our desire to design the ultimate home phone, we focused our efforts on pushing boundaries, both inside and out. Creative engineering inspired the precision crafting and use of innovative materials that are applied on the Motorola IT.6 – the impossibly thin phone!

Measuring less than 6mm at its narrowest point, the handset is made using a real metal frame, ensuring its robustness and a seamless striking form. The crystal base adds to its uniqueness and elegance, from every angle.



Crystal base



Slim handset design



Bluetooth® Wireless Technology



1000 name and number phonebook



Large 2.2" 65K full colour display



Ecomoto is a convergence of efforts by marketing, design, research, engineering, and supply chain management that lead to better products for everyone. It is a holistic view that focuses on both social and environmental responsibility. It is both a passion and a shared point of view.

The right thing to do.

- Meets and / or exceeds EMEA environmental regulatory requirements.
- Eco friendly packaging with a minimum 20% post consumer recycled content.
- Phone housing is built with a minimum of 10% post consumer recycled content plastic.
- Energy efficient charger that meets EU Code of Conduct requirements.
- ECO mode function which reduces the transmitted power and energy consumption.

# IT.6.1

## DISPLAY AND AESTHETICS

|  |  |
|--|--|
| Primary Liquid Crystal Display           | Handset : 2.2" 65K color; full graphic, 176 x 220 pixels TFT LCD |
| Key count                                | Handset : 22 keys<br>Base : 1 key                                |
| LEDs / Indicators                        | YES, 2 x Bluetooth® LED on base                                  |
| Display Backlight                        | YES, integrated in the color LCD module                          |
| Backlit keypad Options                   | YES, full laser etched keypad with white backlight               |
| Set Menu Background Colour               | —  |
| Screensaver in Primary LCD in power save | —  |
| Idle Display                             | Wall paper with time and date                                    |
| Icon Set                                 | Motorola icon set  |
| Other Display Options                    | —  |
| Resident Pictures                        | —  |
| Wallpapers                               | 10 wallpapers  |

## CHARACTER SETS / TEXT

|                             |  |
|-----------------------------|--|
| Font Description            | Normal font : Myriad 22 pt;<br>Zoom font : Myriad 34 pt (used in Pre-dial screen). |
| Word wrap                   | YES  |
| Character type(s) supported | Phonebook : as per section 6.2.1 of 3GPP TS 23.038;                                |

## GENERAL FEATURES

|   |                     |
|---|---------------------|
| GAP Compatibility   | YES                 |
| Multi-base / Handset  | 1 base / 5 handsets |
| Base Station / Handset System Security (PIN code)   | 4 digits            |
| Dialling Mode   | Tone and pulse      |
| Paging From base to handset(s)  | YES                 |
| Three way conferencing (2 internal with 1 external)   | YES                 |
| Three way conferencing plus simultaneous intercom (As above plus additional intercom between 2 internal handsets) | YES                 |

## GENERAL FEATURES

|                                |  |
|--------------------------------|--|
| Auto-talk / Standby            | —  |
| Recall / Flash                 | Timed Break (flash) only, please refer to default settings table for value set |
| Dialling Pause                 | YES  |
| Pre-dialling Facility          | YES  |
| Out-of-range Warning           | Standby : visual;<br>In call : audible and visual                              |
| PABX Access code               | YES  |
| Restore to Default Settings    | YES  |
| Alarm                          | YES  |
| Call Barring                   | YES  |
| Low Battery Warning            | Standby : visual;<br>In call : audible and visual                              |
| Call Timer                     | YES  |
| Handset Power On/Off           | YES, on talk off key   |
| Microphone Mute Facility       | YES  |
| Last Number Redial             | 50 entries -<br>Delete all / Selective delete                                  |
| Display Languages              | 9  |
| Ability To Name Handsets       | YES  |
| Organiser                      | YES, reminder  |
| Keypad Lock                    | YES  |
| Call Transfer Between Handsets | YES  |
| Intercom Between Handsets      | YES  |
| Handset Priority               | —  |
| Easy Call                      | —  |
| ECO Mode and ECO PLUS          | YES, default setting to be OFF in ECO and ECO PLUS menu                        |
| Welcome Mode                   | YES  |

## SOUNDS / AUDIO

|  |  |
|--|--|
| <b>Resident Ringer Melodies</b>        | Handset : 8 melodies + 2 ringtones;<br>Base : 1 ringtone                 |
| <b>Ringer Volume Control</b>           | Handset : 5 Levels + ascending + OFF;<br>Base : On / Off                 |
| <b>Internal Calls</b>                  | Melodies : 1 dedicated ringtone;<br>Volume : 5 Levels + ascending + OFF; |
| <b>Handset Receiver Volume Control</b> | 5 levels (available in-call and via menu)                                |
| <b>Key tone on / off</b>               | YES  |
| <b>Audio Quality Specifications</b>    | —  |
| <b>Handset Amplification</b>           | —  |
| <b>Hands free</b>                      | YES, handset handsfree, shares the same control as earpiece              |
| <b>Hearing Aid Compatibility</b>       | —  |
| <b>Wired Headset Compatibility</b>     | —  |

## PHONEBOOK FEATURES

|  |   |
|--|---|
| <b>Phonebook</b>                         | Handset : 1000 name & number, available in idle/during talk |
| <b>Copy Phonebook across handsets</b>    | —   |
| <b>Menu option to Empty Phonebook</b>    | YES   |
| <b>Save Number in pre-dial mode</b>      | YES   |
| <b>Copy Caller ID entry to phonebook</b> | YES   |
| <b>Copy Redial number to phonebook</b>   | YES   |

## CALLER ID FEATURES\*

|  |   |
|--|---|
| <b>Caller Display In Base</b>  | —   |
| <b>Caller ID Mode</b>  | FSK / DTMF / Bellcore   |
| <b>Other Caller ID modes supported</b>                                       | —   |
| <b>Caller ID Type</b>  | Type 1 and 2  |
| <b>Can see both name and number on the display during incoming Caller ID</b> | YES   |
| <b>Calls List</b>  | 50, dynamic list for received (incoming), missed and redial (outgoing) calls              |
| <b>Caller ID matching to Phonebook</b>                                       | Ringtones : resident - direct assignment  |
| <b>Calls List Includes Time / Date of Call</b>                               | YES, if network does not supply date and time, then this is taken from internal calendar. |

## NETWORK RELATED FEATURES

|  |  |
|--|--|
| <b>Network Services Menu</b>               | Please refer to country setting              |
| <b>Multi-Country Settings</b>              | YES  |
| <b>Option to Disable RPAS</b>              | Please refer to default settings table       |
| <b>Hot Keys</b>                            | Please refer to default settings table       |
| <b>Prefix Dialling</b>                     | —  |
| <b>Area Code Management</b>                | —  |
| <b>Network Voice Mail Indication (FSK)</b> | YES, handset icon subject to network support |

## IT.6.1

Measuring less than 6mm at its narrowest point.



## TECHNICAL CHARACTERISTICS

|                                  |   |
|----------------------------------|---|
| Last Number Redial Memory Length | 24 digits   |
| Phonebook Name Length            | 32 characters (First name – 16 chars, Last name – 16 chars, totally 32) |
| Memory Number Length             | 32 digits   |
| Handset Name Length              | 14 characters   |
| Battery Type***                  | Packed Li-ion   |
| Standby Time*****                | Up to 100hrs  |
| Talk Time*****                   | Up to 7hrs  |
| Range                            | Range indoors / outdoors -<br>Up to 50m / 300m                          |

\* These features require a subscription from your local telephone company.

\*\* Subject to language availability.

\*\*\* Li-ion battery is not accessible by user.

\*\*\*\* All talk and standby times are approximate and depend on features selected and usage pattern.

\*\*\*\*\* Bluetooth enabled mobile phone required. Bluetooth wireless technology provides a wireless connection of up to 10 metres between the phone and other Bluetooth compatible mobile phones. In order for Bluetooth devices to communicate with one another, they must utilize the same Bluetooth profile.

## BLUETOOTH® FEATURES



|   |  |
|---|--|
| Make & receive mobile calls                                       | YES  |
| Make & receive calls either over the fixed line or mobile network | YES *****  |
| Sync your mobile phone contacts                                   | YES *****  |
| Sync mobile phonebooks  | YES, up to 500 entries each for up to 2 mobile phones (3 numbers per entry)***** |
| Bluetooth® connectivity   | YES, connect up to 2 Bluetooth® mobiles phones plus 1 Bluetooth® headset*****    |
| Sync your phonebook via Bluetooth®                                | YES, (includes privacy options)****  |

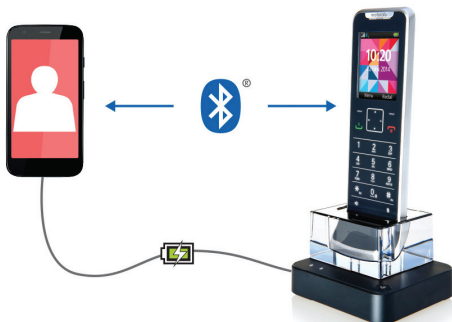

Charge your mobile phone via USB  
(USB cable not included)



Also available in white  
Multi-packs available

Twin Pack IT.6.2 | Triple Pack IT.6.3 | Quad Pack IT.6.4



**For more information, please contact:**

[enquiries@suncorptech.com](mailto:enquiries@suncorptech.com)

### **Digital cordless telephone**

Manufactured, distributed or sold by Suncorp Technologies Ltd., official licensee for this product. MOTOROLA and the Stylized M Logo are trademarks or registered trademarks of Motorola Trademark Holdings, LLC. and are used under license. The Bluetooth® trademarks are owned by their proprietor and used by Suncorp Technologies Ltd. under license. All other trademarks are the property of their respective owners. © 2014 Motorola Mobility LLC. All rights reserved.



**reddot award 2014  
winner**